

CONTRACT: DN01119 PROJECT TIP: DF18314.2075090

See Sheet 1A For Index of Sheets  
See Sheet 1B for Conventional Symbols

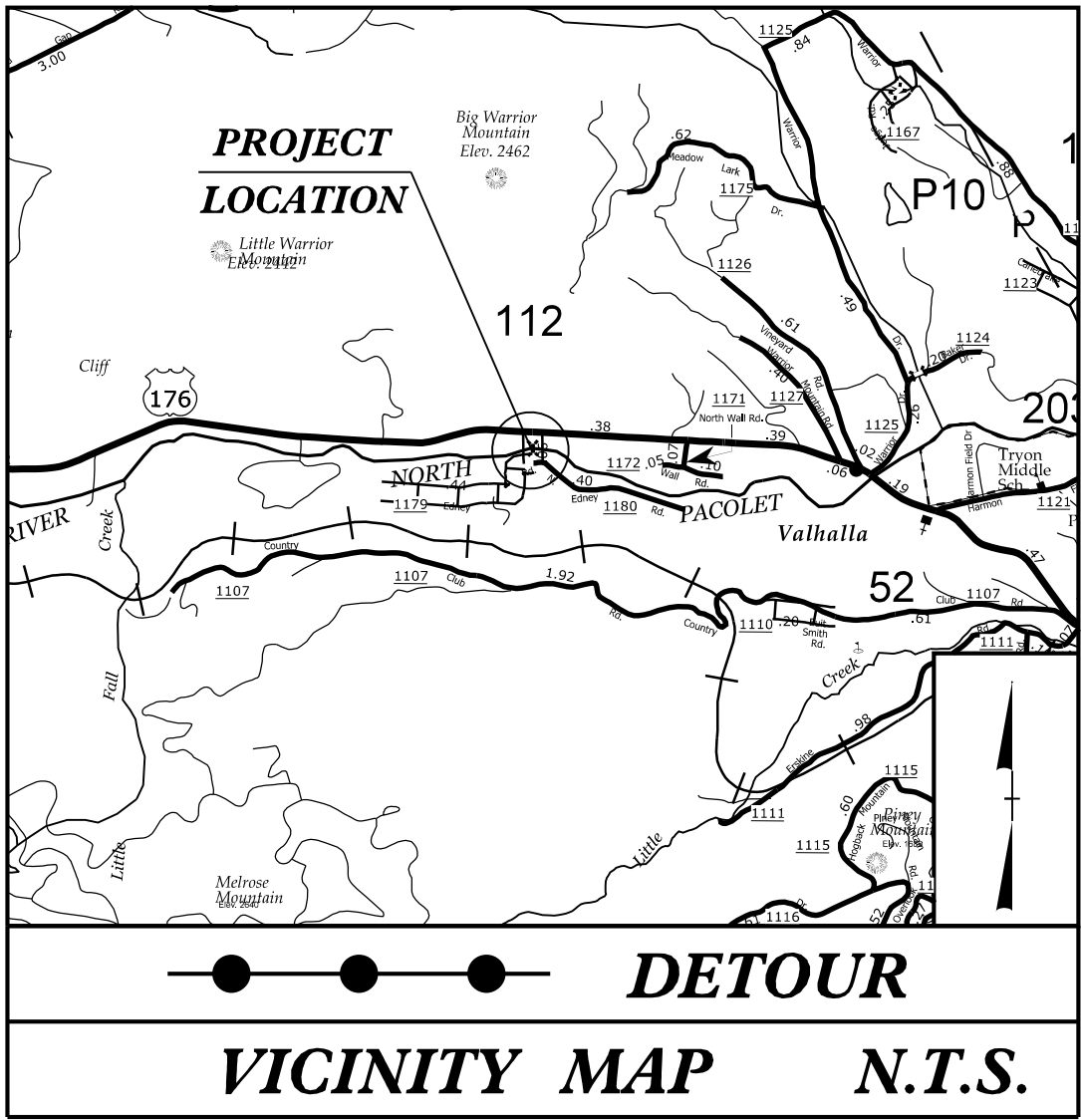

ROADWAY FINAL PLAN SET

STATE OF NORTH CAROLINA  
DIVISION OF HIGHWAYS  
**POLK COUNTY**

LOCATION: BRIDGE 740112 OVER PACOLET RIVER  
ON EDNEY ROAD

TYPE OF WORK: GRADING, DRAINAGE, PAVING, AND STRUCTURE

STATE	STATE PROJECT REFERENCE NO.	SHEET NO.	TOTAL SHEETS
N.C.	DF18314.2075090	1	
STATE PROJ. NO.	F. A. PROJ. NO.	DESCRIPTION	
DF18314.2075090	N/A	PE	
DF18314.2075090	N/A	ROW	
DF18314.2075090	N/A	CON	



BEGIN PROJECT  
DF18314.2075090  
-L- STA. 10 + 50.00

BEGIN BRIDGE  
-L- STA. 11 + 50.00

END PROJECT  
DF18314.2075090  
-L- STA. 13 + 50.00

END BRIDGE  
-L- STA. 12 + 80.00

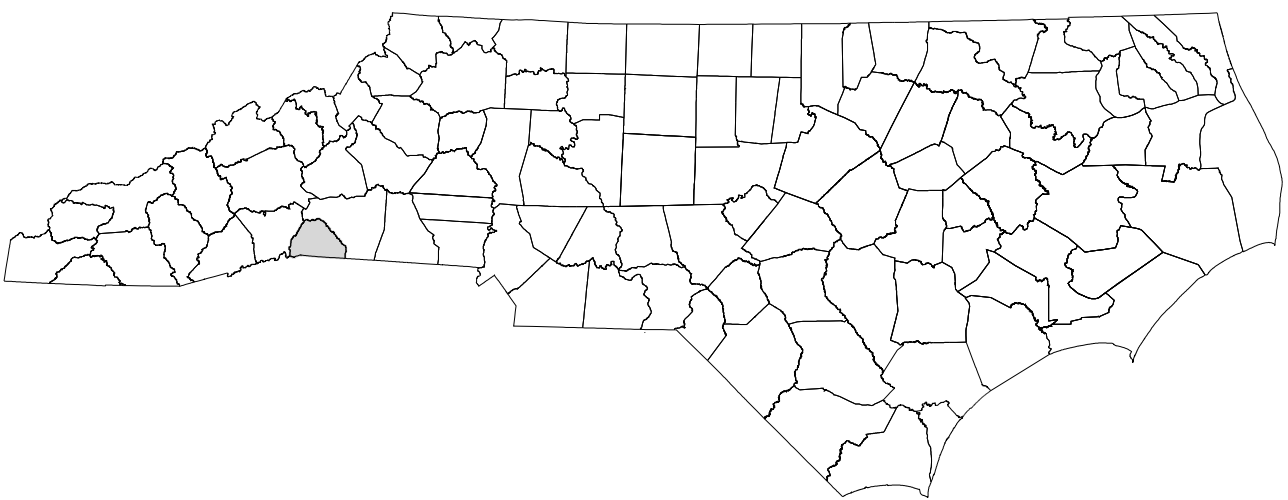

THIS PROJECT IS NOT WITHIN ANY MUNICIPAL BOUNDARIES.  
THERE IS NO CONTROL OF ACCESS ON THIS PROJECT.

DOCUMENT NOT CONSIDERED FINAL  
UNLESS ALL SIGNATURES COMPLETED

GRAPHIC SCALES

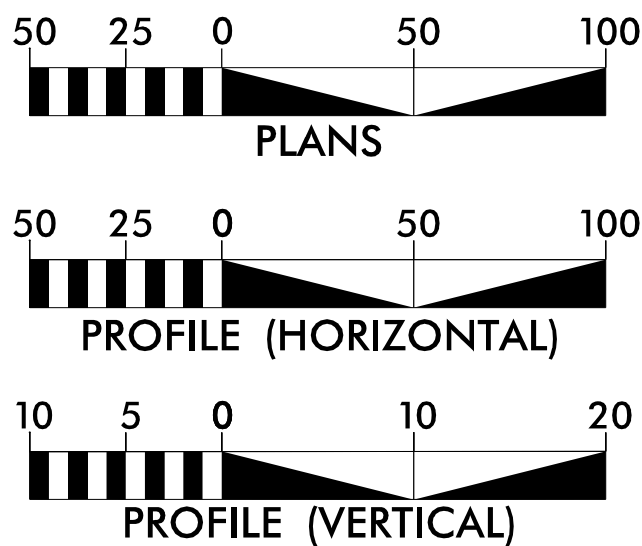

DESIGN DATA

ADT 2025 = < 400  
ADT 2045 = < 400

V = 30 MPH

FUNC CLASS =  
LOCAL  
SUBREGIONAL TIER

PROJECT LENGTH

LENGTH ROADWAY PROJECT DF18314.2075090 = 0.032 MILES  
LENGTH STRUCTURE PROJECT DF18314.2075090 = 0.025 MILES  
TOTAL LENGTH PROJECT DF18314.2075090 = 0.057 MILES

PREPARED IN THE OFFICE OF:

**RS&H**

1520 SOUTH BOULEVARD, SUITE 200  
CHARLOTTE, NC 28203  
NC FIRM LICENSE No: F-0493

FOR THE NORTH CAROLINA DEPARTMENT OF TRANSPORTATION

2024 STANDARD SPECIFICATIONS

RIGHT OF WAY DATE:  
MARCH 2025

LETTING DATE:  
JANUARY 13, 2026

MATTHEW POPPELL, PE  
PROJECT ENGINEER

EMERSON DAVIS  
PROJECT DESIGN ENGINEER

ZACHARY T. SHULER, PE  
NCDOT CONTACT

HYDRAULICS  
ENGINEER

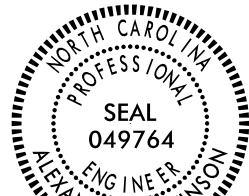

P.E.

DocuSigned by:  
Alexander R Vinson  
90D0FF1E8D1438...

11/18/2025

SIGNATURE:

ROADWAY DESIGN  
ENGINEER



P.E.

Signed by:  
Matthew A Poppell  
F63E22B8CFC9424...

11/18/2025

SIGNATURE:

